

# CONFERENCES AND EVENTS

## RACV INVERLOCH RESORT



AMAZING MEETINGS WITH EVEN BETTER VIEWS

MELBOURNE CBD | YARRA VALLEY | TORQUAY | MORNINGTON PENINSULA  
GOLDFIELDS | INVERLOCH | NOOSA | GOLD COAST | HOBART





## RACV INVERLOCH RESORT

Nestled in the heart of Victoria's spectacular South Gippsland coast, with sweeping views of Bass Strait and Anderson Inlet, is RACV Inverloch Resort. This stunning property provides the perfect venue for events both large and small.

### CONFERENCE FACILITIES

- 200 seated banquet room with multiple configurations available
- 2 ocean-view boardrooms. Can be combined to accommodate 20 guests
- Break-out rooms
- Complimentary Wi-Fi
- High-quality AV equipment

### ACCOMMODATION

- 25 resort rooms
- 26 ocean-view rooms
- 20 two and three bedroom villas
- 20 two bedroom deluxe cabins
- Complimentary Wi-Fi
- Widescreen TV
- Room service

### DINING

- Restaurant
- Lounge bar
- Outdoor BBQ

### GUEST SERVICES

- Lobby shop
- Car parking
- Electric car charging stations

### RECREATION FACILITIES

- Indoor swimming pool
- Spa
- Sauna
- Tennis courts
- Gym
- Games room
- Walking trails

### ATTRACTIONS

- Leongatha 18-hole golf course
- Wineries
- Anderson Inlet beach
- Bunurong Coast Marine Park
- Nearby markets, galleries and shops
- State Coal Mine
- Wilsons Prom day trips
- Prom Country Cheeses

### RACV INVERLOCH RESORT

70 Cape Paterson-Inverloch Road, Inverloch VIC  
 Telephone: +61 3 5674 0000  
 inverlochevents@racv.com.au





LEVEL 1

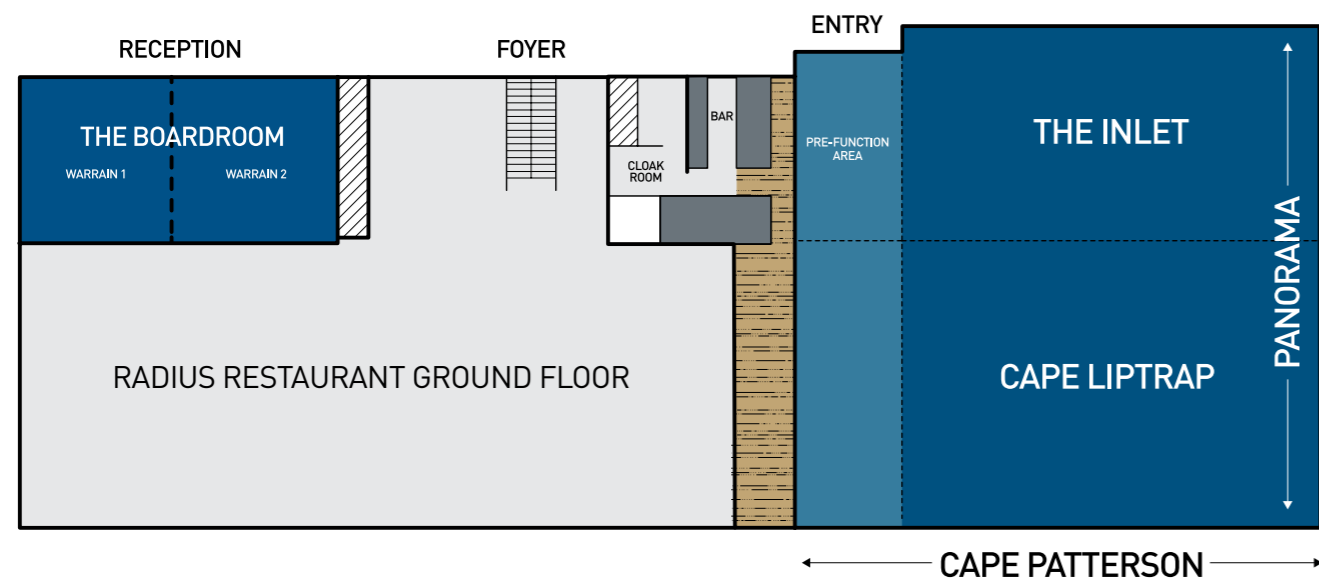

CAPACITIES

ROOM	HEIGHT (m)	AREA (m2)	COCKTAIL STYLE	BANQUET STYLE	CABARET STYLE	THEATRE STYLE	C'ROOM STYLE	B'ROOM STYLE	U SHAPE STYLE	DINNER DANCE
The Inlet	3.5	116	100	60	42	120	60	40	35	-
Cape Liptrap	3.5	152	160	90	63	160	80	50	40	-
Cape Paterson	3.5	200	180	120	84	200	100	60	50	-
Panorama	3.5	352	280	200	140	250	150	80	60	180
Warrain 1	2.9	30	-	-	-	-	-	10	-	-
Warrain 2	2.9	30	-	-	-	-	-	10	-	-
Recreation Room	2.9	122	50	30	-	40	30	20	20	-
The Boardroom	2.9	60	-	20	-	-	-	20	-	-

Main plenary room is a flexible event space that can be divided into multiple spaces forming the below room configurations

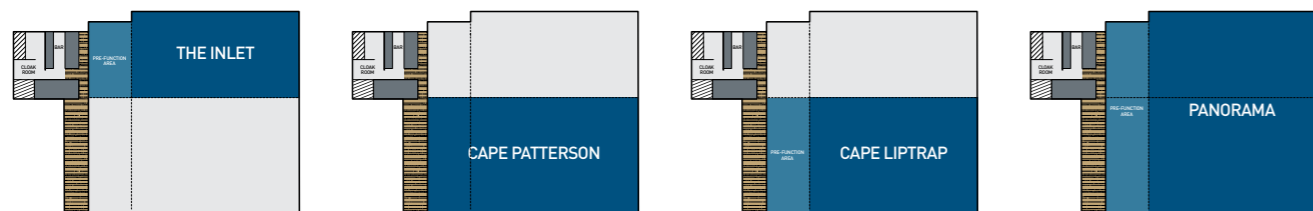



**RACV CITY CLUB**  
 501 Bourke Street  
 Melbourne, Victoria 3000  
 Telephone: 1300 139 059  
[conferencesandevents@racv.com.au](mailto:conferencesandevents@racv.com.au)

**RACV CAPE SCHANCK RESORT**  
 Trent Jones Drive (via Boneo Road)  
 Cape Schanck, Victoria 3939  
 Telephone: 03 5950 8000  
[capeschanck\\_conference@racv.com.au](mailto:capeschanck_conference@racv.com.au)

**RACV NOOSA RESORT**  
 94 Noosa Drive  
 Noosa Heads, Queensland 4567  
 Telephone: 07 5341 6309  
[eventsnoosa@racv.com.au](mailto:eventsnoosa@racv.com.au)

**RACV HEALESVILLE COUNTRY CLUB & RESORT**  
 122 Healesville-Kinglake Road,  
 Healesville, Victoria 3777  
 Telephone: 03 5962 4899  
[healesvilleevents@racv.com.au](mailto:healesvilleevents@racv.com.au)

**RACV GOLDFIELDS RESORT**  
 1500 Midland Highway,  
 Creswick, Victoria 3363  
 Telephone: 03 5345 9600  
[events\\_goldfields@racv.com.au](mailto:events_goldfields@racv.com.au)

**RACV ROYAL PINES RESORT**  
 Ross Street, Benowa,  
 Gold Coast, Queensland 4217  
 Telephone: +61 7 5597 8700  
[royalpines\\_sales@racv.com.au](mailto:royalpines_sales@racv.com.au)

**RACV TORQUAY RESORT**  
 1 Great Ocean Road,  
 Torquay, Victoria 3228  
 Telephone: 03 5261 1600  
[events\\_torquay@racv.com.au](mailto:events_torquay@racv.com.au)

**RACV INVERLOCH RESORT**  
 70 Cape Paterson-Inverloch Road,  
 Inverloch, Victoria 3996  
 Telephone: 03 5674 0000  
[inverlochevents@racv.com.au](mailto:inverlochevents@racv.com.au)

**RACV HOBART HOTEL**  
 154-156 Collins Street,  
 Hobart, TAS 7000  
 Telephone: 03 6270 8600  
[events\\_hobart@racv.com.au](mailto:events_hobart@racv.com.au)

Discover our nine unique destinations at [racv.com.au/venues](http://racv.com.au/venues)  
 For multi-property enquiries email [meet@racv.com.au](mailto:meet@racv.com.au)

Melbourne CBD | Yarra Valley | Torquay | Mornington Peninsula  
 Goldfields | Inverloch | Noosa | Gold Coast | Hobart

